

DIY MECHANISM

STAND ALONE™

wall bed mechanism

If you prefer do-it-yourself, the Pardo DIY Mechanism will suit you perfectly. This stand alone option is cost effective and easy to install ...and can be combined with our DIY Bi Fold Door cabinet for the complete solution.

✓ *Imported European Quality*

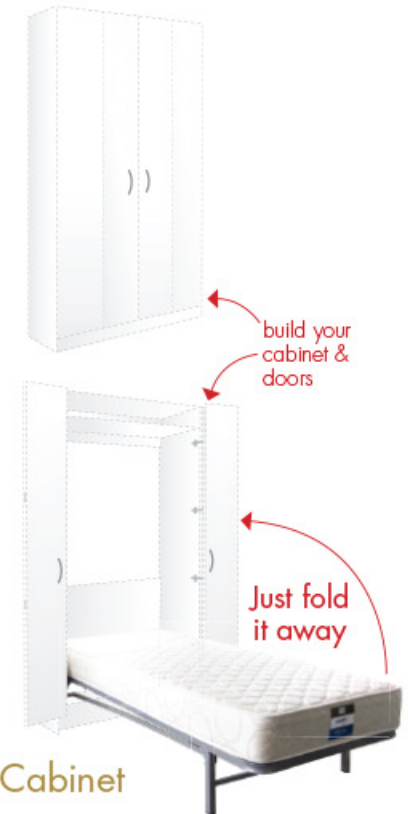

Install independent or with Bi-Fold Door Cabinet



MECHANISM INCLUDES

- Sturdy one piece welded steel bed frame
- Cambered beech slat mattress supports in flexi cups
- Fully enclosed spring mechanism
- Mounting brackets, bolts & screws
- Cabinet cutting list guide
- Comprehensive installation instructions
- 5 year warranty

PRICING - RETAIL

Single	\$700
Double	\$1001
Queen	\$1096

Prices exclude freight
Prices may change without notice

SPACE REQUIRED

SIZE	Width	Cabinet Height	Depth folded out	Cabinet depth
Single	992	2230	2200	500
Double	1492	2230	2200	500
Queen	1592	2230	2350	500

All dimensions shown in millimetres. Approximate dimensions only.
Request instructions for details.

IMPORTANT NOTES

BED FRAME: All wall bed frames feature cambered beech slat mattress supports which allow for the natural curve of the spine while resting. The slat supports are connected to a heavy duty steel frame by flexible support brackets.

MATTRESS: Standard innerspring mattresses are recommended. Maximum mattress thickness is 250mm.

INSTALLATION: All cabinets must be fixed securely to the wall.

OPERATION:

All wall beds **MUST** be carefully lowered to the floor and not left to drop freely.

PRICES: Prices listed are for mechanism only. All cabinetry by others. Mattress sold separately.